

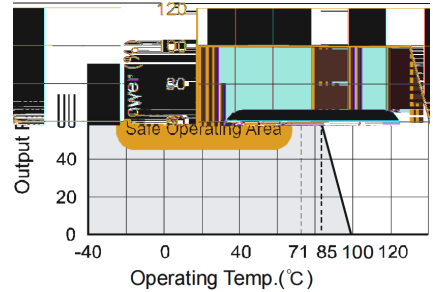

CE REACH



Requirement on output load

no less than 10% load

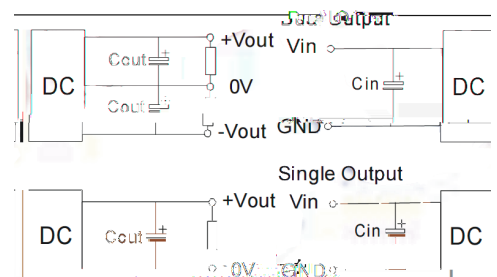

(Figure 1)

Recommended Circuit

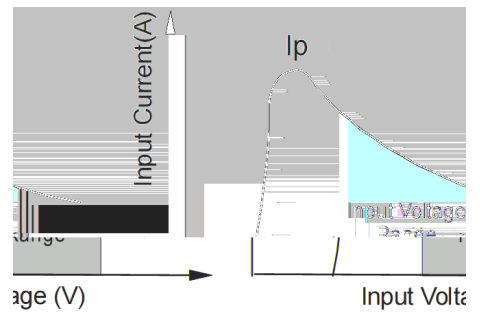

(Figure 2)

Input current

No parallel connection or plug and play

&

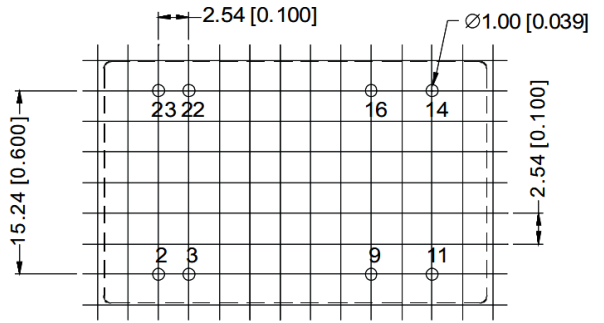
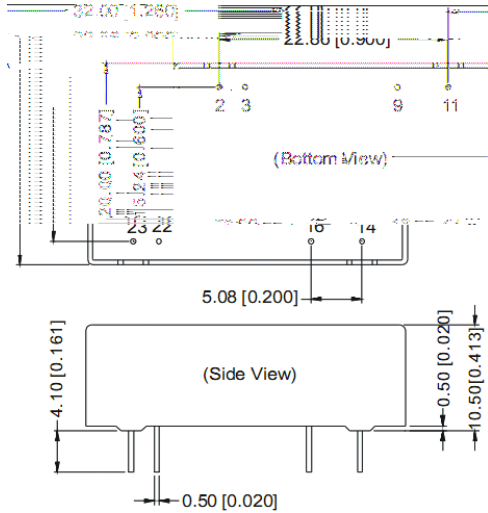

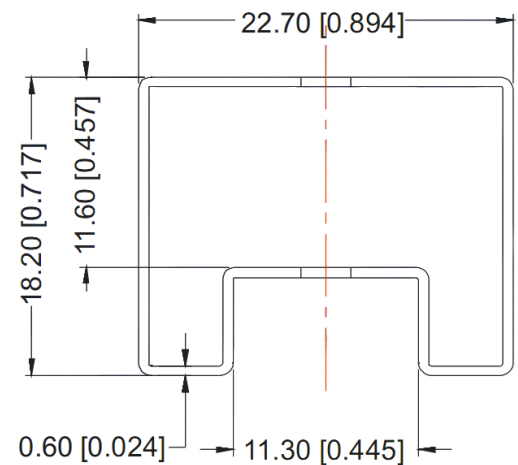

When the environment temperature is higher than 71 , the product output power should be less than 60% of the rated power.
No parallel connection or plug and play.
Use dual output simultaneously, forbid pening output pin (0V) to use as single output.